

# green court

SECTOR 90, GURGAON

Step towards the greener  
beautiful homes...



# location

leading space for a tranquil life

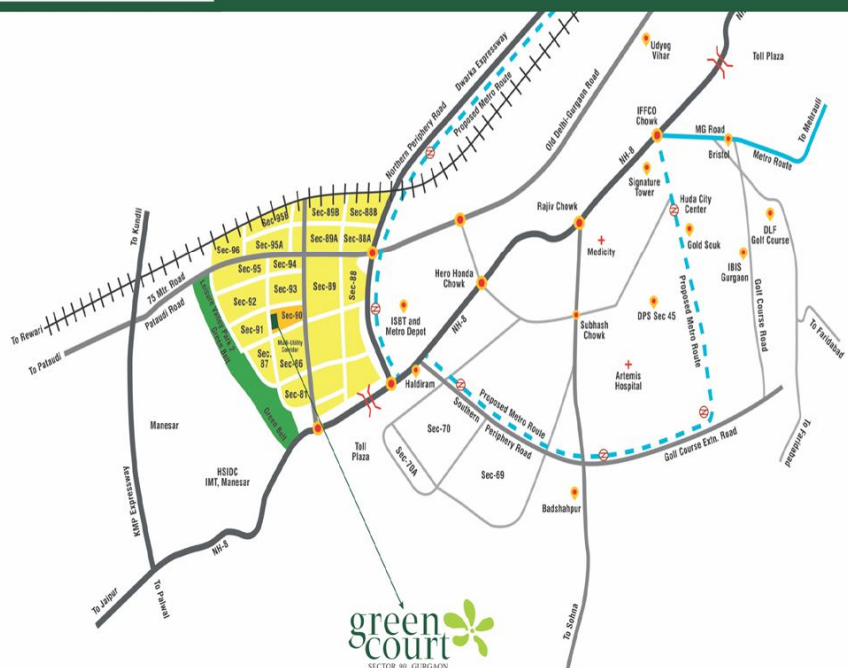

- On Existing 60 mtr. Wide Sector Road
- Approx. 30 Minutes Drive from Delhi
- Approx. 10 Minutes Drive from NH-8
- Well Connected and in close Proximity to Dwarka Expressway, KMP Expressway, Manesar, IGI airport
- Easy Accessibility to Proposed Metro Station and ISBT



## BLOSSOM AMIDST GREEN ENVIRONS

TRANQUIL

# ambience

green aspirations of a serene surrounding

Life is what you make of it. Closeness to nature and green environs, add to your happiness quotient and your existence becomes more beautiful. Green Court affordable homes offer a modern lifestyle with all amenities and a touch of luxury that offers a happy and comfortable experience.

The residence, with green tranquil surroundings, is home to green open spaces. Facilities that not only fulfil all your basic needs, but also allow you to sit back, unwind and relax in the lap of nature; with serenity-filled days and nights, you feel blessed as you can enjoy the fruits of your hard work and live your life to the fullest.

- Elegantly Designed Towers
- Large Lush Green Park
- Well Designed Beautiful Pathways





AN EXPERIENCE CLOSE TO YOUR HEART



NATURE

# calling

life is prized when bound by nature

Green Court is a dwelling space for health-conscious and those who dream of leading a life of excellence, with a relaxed mind and body. Nestled amidst the greens, the residence exudes exuberance and a fresh atmosphere of confidence among its residents. With the landscaped gardens, and separate play area for children, the residence becomes a paradise for families.

Taking care of today's work-life balance, encouraging healthy living facilities are offered to the residents within the complex. Elderly can take a leisurely stroll, office-goers can go for a run or a yoga session and kids can play for as long as they want in the parks – all activities carried out at the residence, contribute to the upkeep of a green-sustainable living community, where the nature has the upper hand.

- Beautifully Landscaped Garden
- Maintained Seating Area
- Paved Walkways
- Yoga and Meditation Area
- Children Play Area



green  
court  
SECTOR 90, GURGAON



# THE project

a home long wished for...

What makes a structure of brick and cement, a home is what makes Green Court stand out from the rest. The residence, with contemporary architecture offering a wonderful day-night view from its balconies is nothing less than a dream home. Everything from the design to the landscaped gardens, the focus has been on quality right from the inception till the completion of the project.

The project has been well-planned; and minute attention has been paid to every detail to ensure its residents, a locality with a balanced commercial and residential use and promote harmony among all. With an endeavour to ensure safety, earthquake-resistant RCC framed structure has been designed for its construction.

- Vastu-friendly Layout
- Spacious Balcony
- Well Lit & Ventilated Apartments
- Majestic Entrance
- Wide Roads with Planned Pathways





# shopping

a comfort zone for residents

From everyday needs to lifestyle products, Green Court Commercial is the place to be. The commercial space is home to all kinds of superstores, general stores, grocery stores, and lifestyle stores, catering to people from all age-groups. To add to the fun and overall indulgence, the complex has provision for multi-cuisine restaurants and fast-food joints. For an exceptional gastronomical experience, the diners would be treated to a serene setting with exquisite food and scrumptious delicacies.

- Well Organised Retail
- Provision for Grocery Stores and Hyper Market
- Multi-cuisine Restaurants
- Fast Food Joints
- Banks and ATMs



green  
court

SECTOR 90, GURGAON



## SITE PLAN

### LEGENDS :

1. Entry/Exit
2. Driveway
3. Parking
4. Silt Parking Entry
5. Pathways
6. Paved Deck
7. Lawn
8. Aromatic Lawn
9. Kids' Play Area
10. Water Feature
11. Toddler's Lawn
12. Senior Citizen Lawn
13. Meditation Lawn
14. Mangrove Pathways
15. Badminton Court
16. Pavilion
17. E.S.S
18. Creche/Aanganwadi
19. Commercial Block-1
20. Commercial Block-2
21. Community Hall



## KEY

# features

open up to endless greens

- Approx. 10 Minutes Drive from NH-8
- Well Connected and in Close Proximity to Dwarka Expressway, KMP Expressway, Manesar, IGI airport
- Easy Accessibility to Proposed Metro Station and ISBT
- Earthquake Resistant RCC Frame Structure
- On Existing 60 Mtr. Wide Sector Road
- Vaastu Friendly Layout
- Well Lit & Ventilated Apartments
- Spacious Balcony
- Beautifully landscaped Gardens with Water Features
- Majestic Entrance with Landscaping
- Community Hall
- Swings & Sand Pits for Kids
- Central Park & Play Ground
- Children Play Area
- Tree-Lined Avenues and Walkways
- Single Entry/Exit - Fully Fenced
- Sports facilities like Badminton, Table Tennis
- Fire Alarm and Fire Fighting Systems
- Two Elevators for Each Block
- Round the Clock Security
- Wide Roads with Planted Pathways
- Convenient Shopping Complex
- Creche / Aanganwadi

## TYPICAL FLOOR PLANS OF 1&2 BHK

### 1 BHK UNIT PLAN - CATEGORY - I

1 Bedroom + Drawing Room  
Carpet Area : 320 sq. ft.  
+ Kitchen + 1 Toilet + Balcony  
Balcony Area : 98 sq. ft.

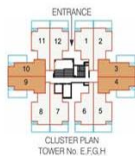

### 1 BHK UNIT PLAN - CATEGORY - II

1 Bedroom + Drawing Room  
Carpet Area : 336 sq. ft.  
+ Kitchen + 1 Toilet + Balcony  
Balcony Area : 96 sq. ft.

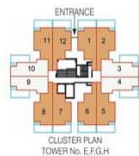

### 2 BHK UNIT PLAN - CATEGORY - III

2 Bedroom + Drawing cum Dining Room  
Carpet Area : 526 sq. ft.  
+ Kitchen + 2 Toilet + Balcony  
Balcony Area : 100 sq. ft.

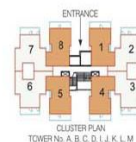

### 2 BHK UNIT PLAN - CATEGORY - IV

2 Bedroom + Drawing cum Dining Room  
Carpet Area : 590 sq. ft.  
+ Kitchen + 2 Toilet + Balcony  
Balcony Area : 100 sq. ft.

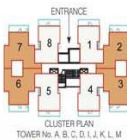



**SHREE VARDHMAN CITY**  
50.125 Acre Township  
Sector -30 , NH-1, Kurukshetra



**SHREE VARDHMAN SHOPPING MART**  
Shopping Centre  
Sector -67, Gurgaon

Shree Vardhman Group is having more than two decade experience in development, marketing, and promotion of various residential and commercial projects. The Group is developing more than 10 million sq.ft. of residential and commercial properties in North India. The qualities that set the group apart amongst its contemporaries are its privileged view point and daunting passion. Every endeavor and effort clearly emphasises the credibility and integrity of the group. The group is well known for its commitment to quality and transparency in its projects. The projects of group are located at most prime locations in Gurgaon, Sonapat, Kurukshetra and Panchkula.

Shree Vardhman Group has carved a niche for its self in the real estate industry in India, having approx. more than 7000 satisfied customers in its various projects.

[www.shreevardhmangroup.com](http://www.shreevardhmangroup.com)



**SHREE VARDHMAN GARDENIA**  
14 Acre Group Housing  
Sector - 10, Sonapat



**SHREE VARDHMAN VICTORIA**  
10.96 Acre Premium Group Housing  
Sector - 70, Gurgaon



**SHREE VARDHMAN FLORA**  
10.88 Acre Group Housing  
Sector - 90, Gurgaon



**SHREE VARDHMAN MANTRA**  
11.26 Acre Group Housing  
Sector - 67, Gurgaon



**SHREE VARDHMAN MY HOMES**  
Luxurious Independent Floors  
Sector-30, NH, Kurukshetra



**SHREE VARDHMAN OLIVE**  
10.75 Acre Group Housing  
Sohna, Gurgaon Road



**SHREE VARDHMAN HIGHWAY MALL**  
2 Acre Retail Mall and Multiplex  
on NH-1, Kurukshetra



**SHREE VARDHMAN SHOPPING PLAZA**  
Shopping Centre  
Sector - 10, Sonapat



# green court

SECTOR 90, GURGAON

## ASTER INFRAHOME PVT. LTD.

CIN No. : U70200DL2011ETC218501

Corporate Office : 24A, Ground Floor, Vipul Agora Complex,  
M.G. Road, Gurgaon - 122002 • Ph. : 0124 - 4501050

Site Office : Green Court, Sector - 90, Gurgaon

Shree Vardhman Group Office : 301-311, 3rd Floor, Indraprakash Building, Barakhamba Road,  
Connaught Place, New Delhi - 110001 • Ph. : 011 - 43605560 (100 Lines)  
Website : [www.shreevardhmangroup.com](http://www.shreevardhmangroup.com)

Santur Group Office : E - 6, Ground Floor, Greater Kailash, Part - 1,  
New Delhi - 110048 • Ph : 011 - 46548102 - 103 - 104  
Website : [www.santurprojects.com](http://www.santurprojects.com)

Note : Visual representations shown in this brochure are purely conceptual. All Building Plans, Specifications, Layout Plans etc.  
are tentative and subjects to variation and modification by the company or the competent authorities sanctioning plans